

11

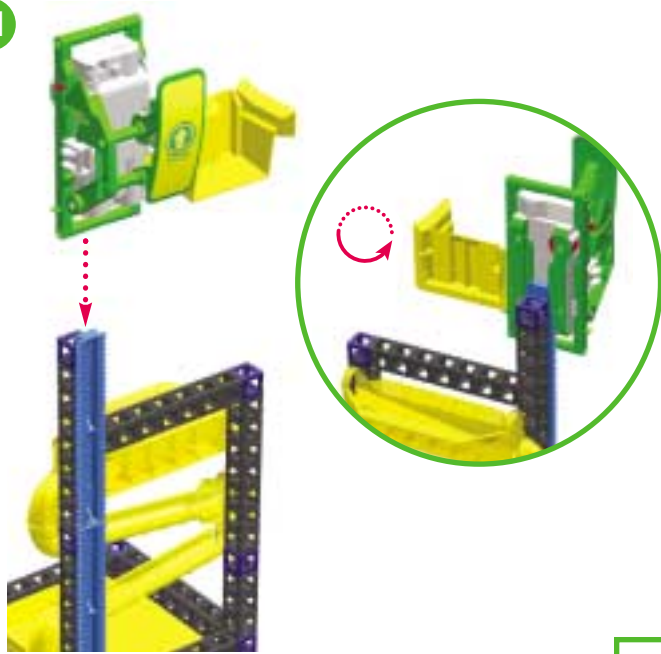

12



How you can add the Power ROK-Lift to any Start Set, here is an example...



1

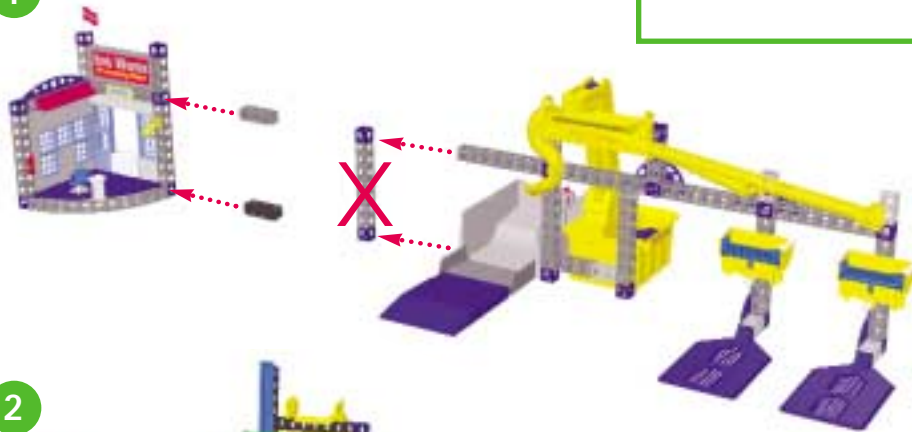

2

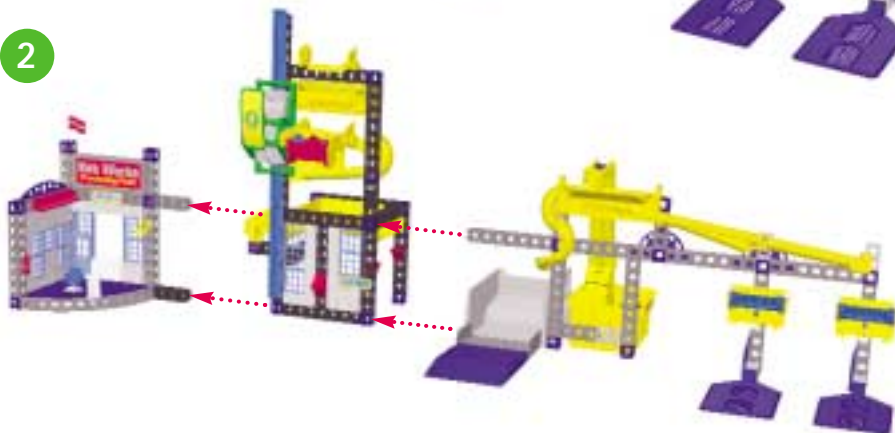

3

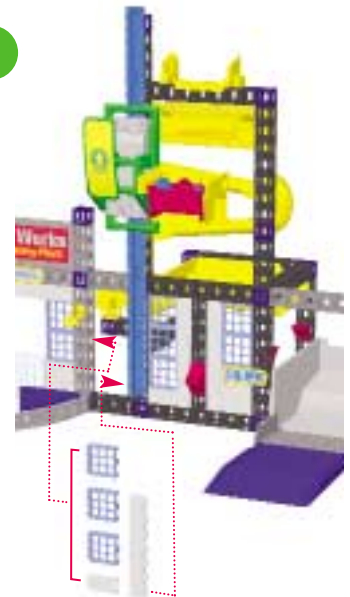



Batteries are to be inserted with correct polarity.
 Las baterías se deberán insertar con la polaridad correcta.
 Les batteries doivent être placées avec la bonne polarité.
 Die Batterien müssen mit der richtigen Polarität eingelegt werden.
 Le batterie devono essere inserite con la corretta polarità.
 Batterijen Moeten Met de Juiste Polariteit Ingezet Worden.
 Batterierna ska sättas i rätt polar.
 Batteriene skal settes i rett polar.
 Batterier skal indsættes med den korrekte polaritet.

